

Specifications for GV Smart Combo Tab Tensioned Screen

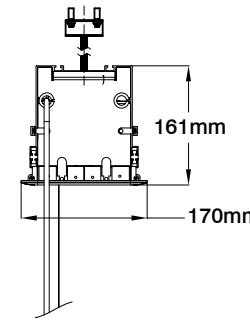
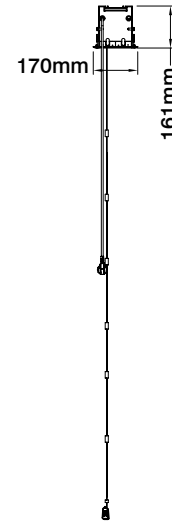
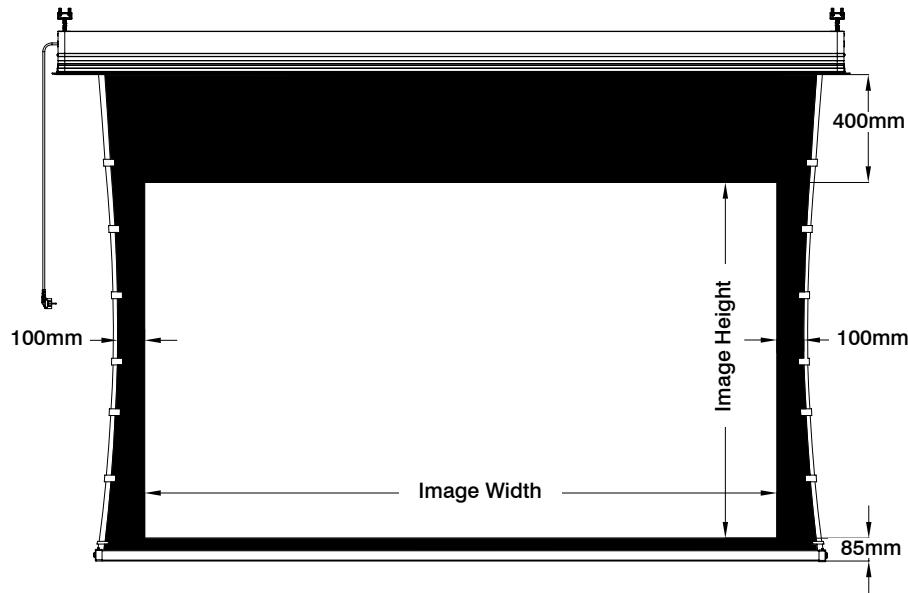

Features:

- Smart Screen multi option control
- Cinema Quality, tab tensioned screen surface
- Delivered pre-fitted into a unique above ceiling pre-installation box
- Featuring unique noise isolation design to reduce any possible noise transfer between the screen's casing during operation and the ceiling cavity
- Standard aspect ratio 16:9, also available in 4:3 and 16:10 (Contact Herma)

Smart Features:

- 12 V Trigger Using 1.5mm output on screen and 3.5 on the projector end
- External IR Cable with Jack plug 3.5mm with receiver eye
- Close Contact Cable Provided in the box
- RS232 control is available – requires an additional accessory
- Manual Switch located on the bottom of the casing (push button), close to the power cable outlet

| Product Code | Aspect Ratio | Diagonal Size (inches) | Image Size w x h (mm) | Casing Length (mm) | Dropper bar w x h x d (mm) | Shipping Size w x h x d (mm) | Net Weight (kg) | Top Black Leader (mm) |
|--------------|--------------|------------------------|-----------------------|--------------------|----------------------------|------------------------------|-----------------|-----------------------|
| GRSTF106H | 16:9 | 106" | 2347 x 1320 | 2961 | 2665 x 45 x 24 | 3070 x 260 x 226 | 32 | 400 |
| GRSTF120H | 16:9 | 120" | 2657 x 1494 | 3271 | 2975 x 45 x 24 | 3380 x 260 x 226 | 34 | 400 |
| GRSTF150H | 16:9 | 150" | 3321 x 1868 | 3940 | 3640 x 45 x 24 | 4050 x 260 x 226 | 44 | 400 |
| GRSTG120C | 16:10 | 120" | 2585 x 1615 | 3199 | 2905 x 45 x 24 | 3310 x 260 x 226 | 32 | 400 |