

802.11n Wireless Interactive Presentation Gateway

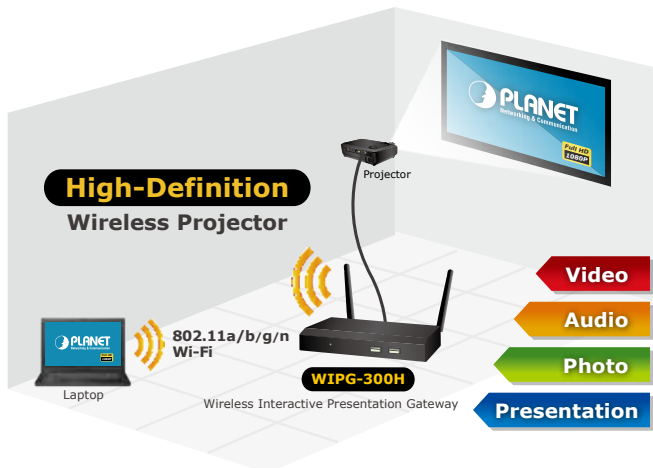

Wireless Interactive Presentation Gateway

PLANET WIPG-300H adopting IEEE 802.11n **dual band** wireless technology brings smooth display through the 300Mbps high-speed wireless connection or the wired 100Mbps Fast Ethernet connection to project the screen of desktop PC, Mac or smartphone to make professional and interactive presentation.



Intelligent 1080p Full HD Wireless Projection

The WIPG-300H can optimize resolution based on the automatically transmitting device. It supports display with multiple resolutions and audio projection disregarding video format and resolution. Its HDMI output resolution can be increased to **1080p** (1920 x 1080 pixels), making it a high-definition display perfect for presentation and video. Thus, the office presenter or the home users can easily share the multimedia on the big monitor/screen with others without the hassle of cabling.



- Wirelessly project multimedia across different platforms.
- Flexible dual-output options with VGA or 1080p Full HD resolution.
- 4-to-1 split screen projection increase efficiency
- Audio and video streaming
- Just Plug & Display by a USB token without any installation
- 802.11n **dual band** Wi-Fi AP and AP-client mode
- Remote control presenter's desktop over USB mouse/keyboard
- USB over IP for touch screen and IWB
- Web-based management interface
- Windows 7/8/10, Mac OS X, iOS and Android support
- WebSlides allows multiple users to view the presentation on any mobile devices
- SidePad receiver allows mobile device to remotely control presenter's desktop
- Its compact size makes installation and placement convenient

Wireless Interactive Touch

Furthermore, the WIPG-300H adopts an interactive feature with IWB (Intelligent White Board) and Mobile apps which enable users to reverse control or synchronize screen display for different platforms. This helps the WIPG-300H achieve a real, full wireless presentation environment.

Mobile Applications

The WIPG-300H supports not only the Windows and Mac platforms, but also the presentation and screen mirroring through the iPad, iPhone, or the android mobile device. Apps for mobile devices working on the WIPG-300H are freely available at Google Play and Apple App Store.

Flexible Projection via Dual Video Output Interfaces

To deliver a perfect presentation solution, the WIPG-300H offers choice of the two types of video output interfaces: the VGA or HDMI connector, which is compatible with most of the popular display devices. With the hardware decoding capability, the WIPG-300H can project high-definition sound film through wireless or wired LAN connections. It facilitates multiple users to freely display the presentations, images and videos via connecting to a projector or LCD TV without complex installation.



4-to-1 Split Screen Projection

With this 4-to-1 split screen feature, the WIPG-300H allows up to four PC / Laptop screens to be projected through one projector at the same time. Therefore, the participants can easily do side-by-side comparison from four PCs / laptops to make the presentation more efficient.



Easy to Use, Plug & Show

The embedded Windows-based utility enables the connected users to directly download the utility from the WIPG-300H web UI or simply execute the utility from the created USB token. It offers the most convenient way for the new user to access the presentation in seconds. Just link the PC / laptop to the WIPG-300H through wireless or Ethernet and the wireless projection can be performed via the connected projector easily.

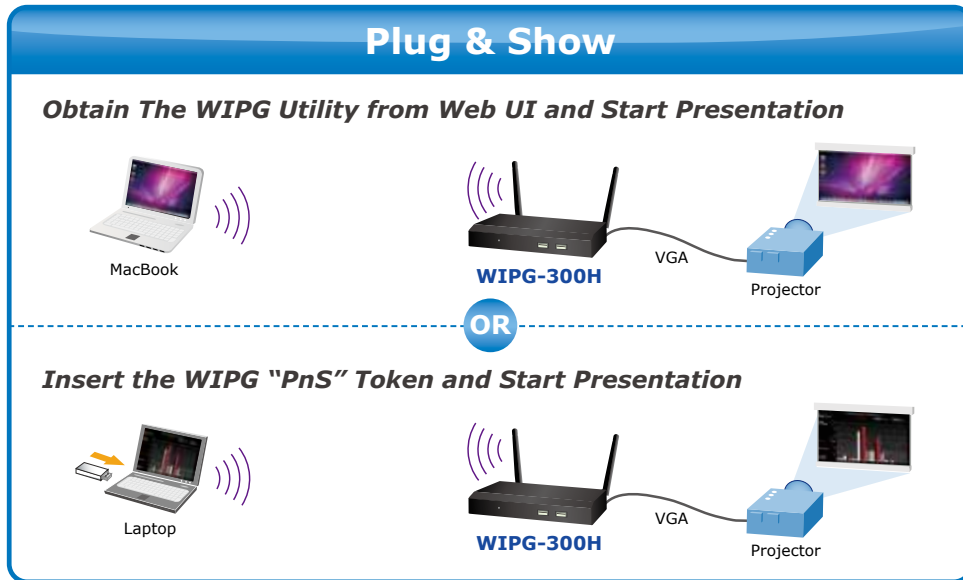

Internet / Intranet Connectivity through AP Client Mode

The WIPG-300H is also a Wireless Access Point. Its 10/100Mbps LAN port and 11n wireless performance ensure the participants in the meeting that they are able to access the Internet and Intranet all the time, even while wireless presentations are projecting. You just need to activate the AP-Client mode function to let the WIPG-300H join the existing Access Point through Wi-Fi. This feature provides the flexibility of wireless network deployment in enterprise environment.

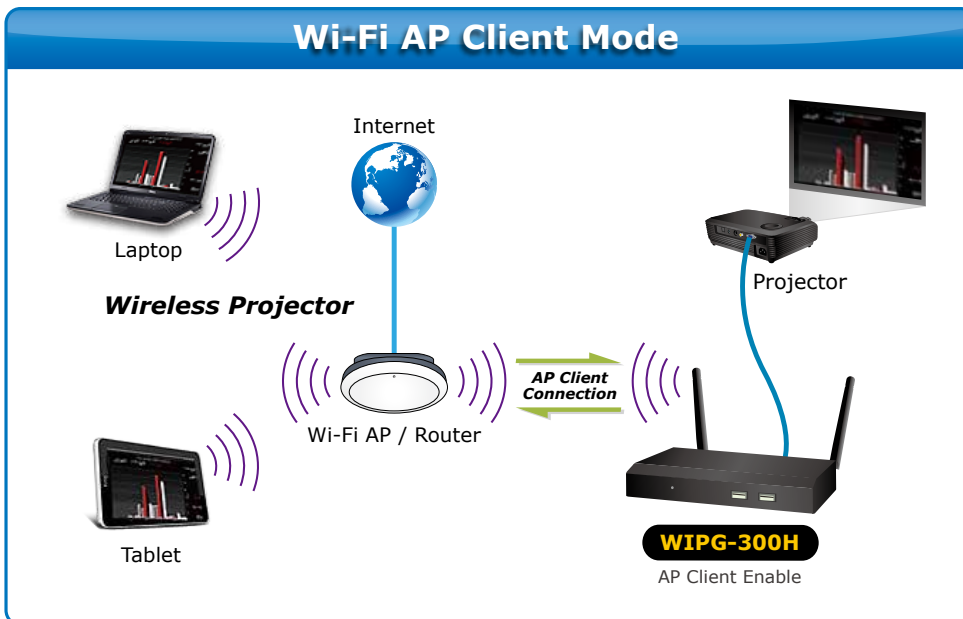

Remote Desktop





Plug standard USB keyboard or mouse into the USB port on the front panel of the WIPG-300H to enable you to control your PC remotely. You don't have to stand still beside the PC or the WIPG-300H, thus delivering your presentation easily and freely.

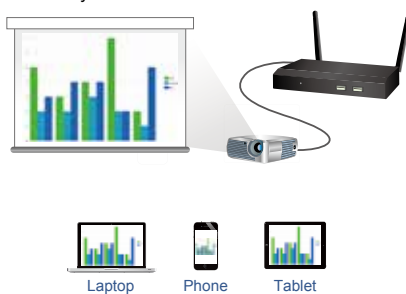

Applications

Interactive Presentation with VoIP and Mobile Apps

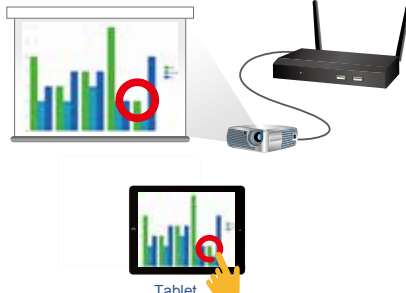
The WIPG-300H features VoIP (**USB over IP**) technology which can connect touch screen by using USB cable to wirelessly control the touch screen. There are also iOS and Android Interactive applications provided by the WIPG-300H such as **Web Slides** that can allow audience to use web browser to view the speaker's slides; or the **Sidepad** function to control the projection screen on PC or Mac via mobile devices.

<p>Web Slides</p> <p>Open your web browser and view presentation slides on your devices</p>  <p>Laptop Phone Tablet</p>	<p>Remote Mobile Control</p> <p>MirrorOp Receiver for mobile devices to operate your laptop remotely when projecting</p>  <p>Tablet Laptop</p>
<p>MirrorOp Presenter</p> <p>Flexible for presenters with mobile devices</p>  <p>Tablet</p>	<p>Photo Projection</p> <p>Present your lovely photos through WIPG</p>  <p>Smart Phone</p>

4-to-1 Split Screen Display through High-speed Wireless LAN

Just connect the WIPG-300H to the HDMI / VGA interface of the projector and users can immediately experience the convenience of presentation. Adopting the latest generation screen projection technology, the WIPG-300H's screen workflow goes smoothly via 300Mbps wireless transmission. Moreover, the WIPG-300H enables four users to wirelessly project their presentations in the main screen at the same time, thus bringing higher efficiency of meetings and group discussions.

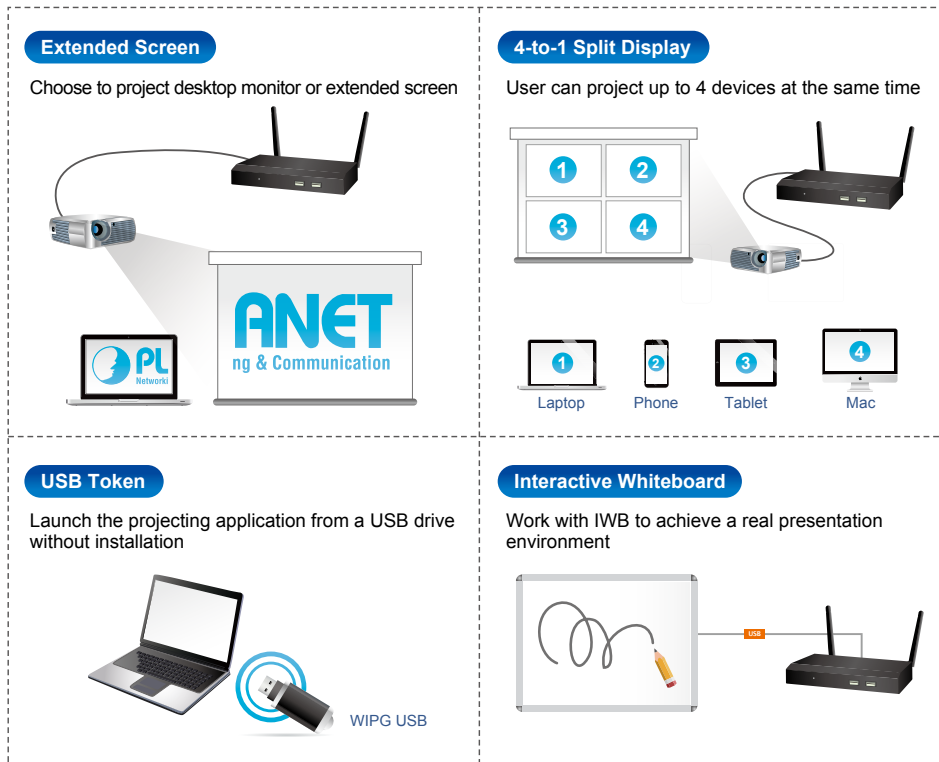

Specifications

Product	WIPG-300H	
Hardware Specifications		
Interfaces	Video	VGA Port: D-sub 15-pin female port HDMI 1.4b
	Audio Out	3.5mm stereo jack
	LAN	10/100BASE-TX RJ45
	Wireless LAN	IEEE 802.11a/b/g/n 5GHz/2.4GHz selective 300Mbps
	USB Port	3 x USB 2.0, Type A, 5V DC, 0.5A output
Antenna	Gain	2 x 2dBi RP-SMA detachable dual dipole antenna
	Orientation	Omni-directional
LED Indicators	Green: Power on Red: Init / firmware upgrade	
Material	Metal	
Dimensions (W x D x H)	150 x 59 x 25mm	
Weight	243g	
Power	External power adaptor: 5V DC input, 2.6A Multi-type swappable plug: US, EU, UK, AU	
Reset Button	> 10 sec while booting: reset to factory default	
Wireless Interface Specifications		
Standard	Compliance with IEEE 802.11n Backward compatible with IEEE 802.11a/b/g	
Frequency Band	2.4GHz	FCC: 2.412~2.462GHz ETSI: 2.412~2.484GHz
	5GHz	FCC: 5.180~5.240GHz, 5.725~5.850GHz ETSI: 5.180~5.240GHz
Wireless Data Rate	Up to 300Mbps	

Wireless Channel	2.4GHz	FCC: 1~11 ETSI: 1~13
	5GHz	FCC: 36, 40, 44, 48, 149, 153, 157, 161, 165 ETSI: 36, 40, 44, 48 5GHz channel list may vary in different countries according to their regulations.
Receive Sensitivity	802.11b: less than -80 dBm (11Mbps) 802.11g: less than -70 dBm (54Mbps) 802.11n: less than -61 dBm at HT40 MCS7 802.11n: less than -64 dBm at HT20 MCS7	
Wireless Security	IEEE Standard 64/128 bit WEP / WPA / WPA2-PSK	
Operation Mode	<ul style="list-style-type: none"> ■ AP (Access Point) ■ AP Client 	
Wireless Client	Supports max. 15 clients	
Video Display		
Supported Output Resolution	VGA: SVGA (800x600) / XGA (1024x768) WXGA(1280x768) / WXGA(1280x800) WXGA (1360x768) / WXGA+ (1440x900) UXGA (1600x1200) HDMI: 720p (1280x720) / 1080i (1920x1080) / 1080p (1920x1080)	
System Management		
Protocol	TCP/IP	
IP Configuration	Automatic: DHCP Manual: Static IP address	
Management	Web-based configuration	
Supported Windows Account Right	Administrators Limited user Guest	
Supported Operating System	<ul style="list-style-type: none"> ■ Windows 7 / 8 / 10 <ul style="list-style-type: none"> ▪ CPU: Dual core 1.8GHz or above ▪ VGA: nVIDIA/ATI graphic card with 64MB VRAM or above ▪ RAM: 8GB DDR3 or above * Recommend at least Intel Core i5 2.6GHz for video streaming ■ Mac OS X 10.9 and above <ul style="list-style-type: none"> ▪ CPU: Intel Dual Core 1.4GHz or above ▪ VGA: nVIDIA/ATI graphic card with 64MB VRAM or above ▪ RAM: 8GB DDR3 or above ■ Android 4.1 and above ■ iOS 8 and above 	
Language Support	English Traditional Chinese Simplified Chinese Japanese Korean French	

Software Features

Software Name: MirrorOp Sender		
Platform	Windows	MacOS
4-to-1 Split Screen	■	■
Audio Projection	■	■ Extra utility required
Document Projection	■	■
Photos Projection	■	■
Video Projection	■	■
Virtual Extended Desktop	■	■
Conference Control	■	■
Gatekeeper	■	■
*Webslides	■	■

Software Name: MirrorOp Presenter		
Android	iOS	MacOS
4-to-1 Split Screen	■	■
Document Projection	■	■
Photos Projection	■	■
*SidePad App: MirrorOp Receiver	■	■
*Webslides	■	■

Remarks:	
SidePad Feature	Allows mobile device to remotely control presenter's desktop through the MirrorOp Receiver App.
Webslides Feature	Allows audiences to view the presentation and save single slide directly on any mobile devices. Supports max. 35 clients (update interval: 90 seconds). * Strongly recommend to use LAN connection for the webslides feature when wireless session exceeds 10 users.

Standard Conformance

IEEE Standards	IEEE 802.11n (2T2R, up to 300Mbps) IEEE 802.11g IEEE 802.11b IEEE 802.11a IEEE 802.3 10BASE-T IEEE 802.3u 100BASE-TX
----------------	---

Environment

Temperature	Operating: 0 ~ 40 degrees C Storage: -10 ~ 60 degrees C
Humidity	Operating: 10 ~ 80% (non-condensing) Storage: 10 ~ 90% (non-condensing)

Ordering Information

WIPG-300H	802.11n Wireless Interactive Presentation Gateway
-----------	---

Related Wireless Products

WPG-210N	802.11n Wireless Presentation Gateway
WDL-U601AC	433Mbps 802.11ac Dual Band Wireless USB Adapter